

GENERAL WOLFE SCHOOL

661 Banning Street
Winnipeg, MB. R3G 2G3
Phone: 204-786-7427
Fax: 204-775-2882

Ms. G. McLean, Principal
Mr. L. Mangaron, Vice-Principal

"HOME OF THE WOLFPACK"



General Wolfe School Welcoming Our Students Back September 2020

We are looking forward to welcoming all of our returning students as well as those new to our school to in-class learning! This is certainly not a typical start of the school year, but we would like to assure our students, parents and school community that we have been diligently planning for a safe return to school, by strictly adhering to Public Health orders and with direction from Manitoba Education and the Winnipeg School Division. To this end we would like to share with you some of the routines, protocols and resources in place at General Wolfe School to ensure the physical and mental safety of all students, staff and community. This plan will evolve with last minute changes, as new information becomes available and in response to current Public Health orders. We will continue to provide you with these updates as needed.

On July 30th the province released an update based on Public Health advice which stated that all students would be returning to in-class learning this September. *The Welcoming Our Students Back: Restoring Safe Schools* document provides guidelines for K-12 schools, acknowledging that it looks different in each setting based on the context of each school. The guidelines state that all students in Grades K-8 will attend school every day, and high school students will attend to the greatest extent possible. After careful planning, we have decided that all of our students, grade 7,8 and 9 will attend full time.

This plan provides guidance for the three levels of response planning.

Please see attachment A.

Level 1- In-class Learning- Grade 7-9 students will be in-class every day.

Level 2 – Blended Learning – grade 7-9 students will participate in teacher-led remote learning, with limited use of school facilities.

Level 3 – Remote Learning (with exceptions) – Remote learning in place for all students with limited use of school facilities.

School Start

Class lists will be posted on the school windows on Friday, Sept. 4th. The first day of classes will be September 8th, Day 4. All students are to arrive at school at 8:45 and line-up at the designated doors. Please refer to the map below:

Level 1

	Staff	Students/Parents
1. Safe Operations 	<p>Staff Orientation</p> <p>Daily home screening before leaving for school. https://sharedhealthmb.ca/covid19/screening-tool/</p> <p>Physical distancing</p> <p>Staff training on screening procedures.</p> <p>Mandatory mask policy in school.</p> <p>Hand washing/sanitizing</p> <p>Physical distancing of 1 meter within cohorts, 2 meters when not in cohorts.</p> <p>Provide instructions on the correct use of masks. (See attachment B)</p> <p>Public Health Signage throughout the building.</p> <p>Staff will monitor hallways and washrooms throughout the day to ensure physical</p>	<p>Public Health Orders to be followed at all times.</p> <p>Daily Home screening before leaving for school. https://sharedhealthmb.ca/covid19/screening-tool/</p> <p>If students are ill they must stay home. If students arrive at school with any symptoms they will be provided a medical mask and isolated. Parents/guardians will be contacted immediately and asked to pick up the student. (Current contact information/phone numbers/emails must be up to date).</p> <p>Arrival at School: Students arrive at school at 8:45 am. and 12:40 p.m. To avoid student congestion before classes begin, students will only access the school at 8:45 and 12:40. <i>The school</i></p>

distancing protocols are maintained.

Regular sanitization by custodial staff of all areas throughout the school day; disinfection nightly.

doors will not be open prior to this time.

Students will be given 2 reusable non-medical masks to use at school.

Masks are required in all indoor spaces where physical distancing of 2 meters cannot be maintained.

Students will be assigned an entry/exit doorway where they will line up, ensuring social distancing. (Please see attachment B)

Students will be screened at the doorway by school staff and then escorted to their classroom.

Students will wear their masks while lining up and when moving throughout the school.

Students will remain in their homeroom classrooms, subject teachers will move to the classrooms.

Students will not be assigned a locker. We are requesting all students bring a box or tote to store their school supplies in.

		<p>The box/tote will be kept under their desk.</p> <p>Water fountains will not be accessible. Students are asked to bring a water bottle, which can be filled at our no-touch fill station.</p> <p>Physical distancing of 1 meter will occur in homeroom cohorts.</p> <p>Physical distancing of 2 meters in hallways and non-cohort groups.</p> <p>Students will move to their elective/optional classes within their cohorts.</p> <p>Students will remain in their cohort groups during school hours.</p> <p>Unidirectional flow throughout the building.</p> <p>Students will transition in single lines when moving from class to class.</p> <p>Classroom entry/exit in single lines adhering to social distancing protocols.</p> <p>Hand washing/sanitizing when entering school and throughout the day.</p>
	Staff will provide supervision during the lunch hour.	

<p>Lunch Program</p>	<p>Staff will prepare breakfast and lunch following food preparation guidelines.</p> <p>Shops teacher will provide programming for students.</p>	<p>Students will exit the building in a single line under staff supervision. There will be limited access by the community: please call to make an appointment before coming to the school.</p> <p>Parents will drop off and pick up their children in the designated drop off/pick up sites. (Please see attachment.</p> <p>Students who live a distance from school or with extenuating circumstances will be allowed to stay for lunch. (Parents are to contact the school to have their child/children register for the lunch program.) Attachment D.</p> <p>Students will eat and remain in their homerooms throughout the lunch hour.</p> <p>Students will bring their own lunch. (No microwave access).</p> <p>Students may pre-order lunch and or breakfast from the Nook on a weekly basis. (Breakfast \$1.00- Lunch \$3.00)</p>
----------------------	--	---

Shops	<p>At this time grade 7 and 8 shops will be provided at General Wolfe.</p> <p>Grade 9 students will attend shops at GW and DMCI.</p>	
-------	--	--

<p>11 Learning</p> 	<p>In class assessments to determine student learning needs.</p> <p>Programming for students based on the assessments.</p> <p>Resource/Guidance/CSS support will be provided as needed.</p> <p>Recovery learning will occur throughout the school year and will focus on the essential learning outcomes.</p>	<p>All students are expected to be engaged and participate in their learning.</p>
--	---	---

<p>111 Well-Being and Protection</p>	<p>Professional development will focus on recovery learning and engaging students in learning.</p> <p>Clinical Student Services presentation for all staff.</p> <p>Guidance, CSS team and Resource to support at-risk students.</p> <p>Guidance, CSS team to provide direct in-class support on mindfulness and well-being.</p> <p>Divisional on-line suicide prevention training.</p> <p>Attendance monitoring and follow-up by administration and support team.</p> <p>Provide mental health resources for families.</p>	<p>School support team available to students as required.</p> <p>Parents/student advocate for support as needed.</p>
<p>IV Communication</p>	<p>Staff/administration accessible through email. See webpage for email addresses.</p>	<p>Parents/guardians contact the school when students are absent.</p>

	<p>Information will be provided through email, School Connect and our electronic sign.</p> <p>Maintain regular communication with families throughout the year.</p>	
--	---	--

RESPONSE LEVEL PLANNING

PROVINCIAL

LEVEL 1: IN-CLASS LEARNING

IN-CLASS LEARNING RESUMES FOR ALL

All Kindergarten to Grade 8 students and students with special needs will return to in-class learning 5 days per week.

Grades 9 to 12 students will be in-class to the greatest extent possible. Blending learning may vary from school to school.

Physical distancing is required, maintaining a distance of two metres where possible.

When physical distancing is not possible, students will be arranged into cohorts and assigned to a teacher for a minimum of 15 minutes.

Non-essential areas are strongly recommended for staff and students in Grades 9 and 10. Common areas throughout the school and where physical distancing cannot be maintained.

Breaks will be required when physical distancing is not possible for all students in Grades 9 and above.

Field trips, assemblies and other large events will not be held.

Core curriculum and required courses will be prioritized.

Electives may be offered where they do not affect education requirements. Some may be offered via distance/remote learning.

LEVEL 2: BLENDING LEARNING

(in-class and remote)

K-8 students and students with special needs will be prioritized for in-class learning.

Grades 9 to 12 will participate in teacher-led remote learning, with limited use of school facilities for specific programming and assessment.

Physical distancing is required, maintaining a distance of two metres where possible.

Smaller groupings of students may be required.

Core curriculum and required courses will be prioritized.

LEVEL 3: REMOTE LEARNING

(in-class and remote)

Remote learning and limited use of schools. Return to remote learning.

- Emphasis on mental health and addressing the impact of school closures
- Ensure connectivity for students
- Professional development/support for educators and families
- Staff and students connecting on a weekly basis
- Expanded Food Security Initiative
- Play structure closures

Change of response level is subject to rate of community transmission of COVID-19

WSD

LEVEL 1

In-class learning resumes

K to 8: All students return daily

9 to 12: Students return to the greatest extent possible

- Emphasis on mental health and addressing the impact of school closures
- Staggered class times
- Using common areas to increase capacity of schools
- Cohorting and limiting group/class size
- Limiting visitors in facilities
- Limited WSD transportation available
- Modified nutrition programming
- Expanded Food Security Initiative

LEVEL 2

K to 8 and students with special needs prioritized for in-class learning.

9 to 12: Teacher-led remote learning.

LEVEL 3

Remote learning and limited use of schools

Return to remote learning

- Emphasis on mental health and addressing the impact of school closures
- Ensure connectivity for students
- Professional development/support for educators and families
- Staff and students connecting on a weekly basis
- Expanded Food Security Initiative
- Play structure closures

Attachment B – Masks

Masks are mandatory for all students 4-12 when physical distancing of 2 meters cannot be maintained and on school busses. Masks will be worn when lining up to enter the school, upon dismissal and when moving throughout the school building.

All students will be given 2 reusable masks to be worn at school.

To be effective, masks must be worn properly.

You must do the following:

Wash your hands immediately before putting the mask on and immediately after taking the mask off.

Practice good hand hygiene while wearing the mask.

Ensure your mask fits well and covers your nose, mouth and chin.

Do not share your mask with others.

Avoid touching your mask or face while wearing the mask.

If you need to adjust your mask, wash your hands immediately afterwards.

Do not dangle your mask from one ear, or pull it below your nose or your mouth so that it is covering your chin. Visit

<https://www.gov.mb.ca/covid19/prepareandprevent/index.html> for the latest guidance on the use and care of masks.

ATTACHMENT C: ENTRANCE/EXIT DESIGNATIONS

S1

Burnell Street

GENERAL WOLFE SCHOOL ENTRANCE/EXIT DESIGNATIONS

School Field

Basketball Court

B
A
C
K

L
A
N
E

E
L
L
I
C
E

A
V
E
N
U
E

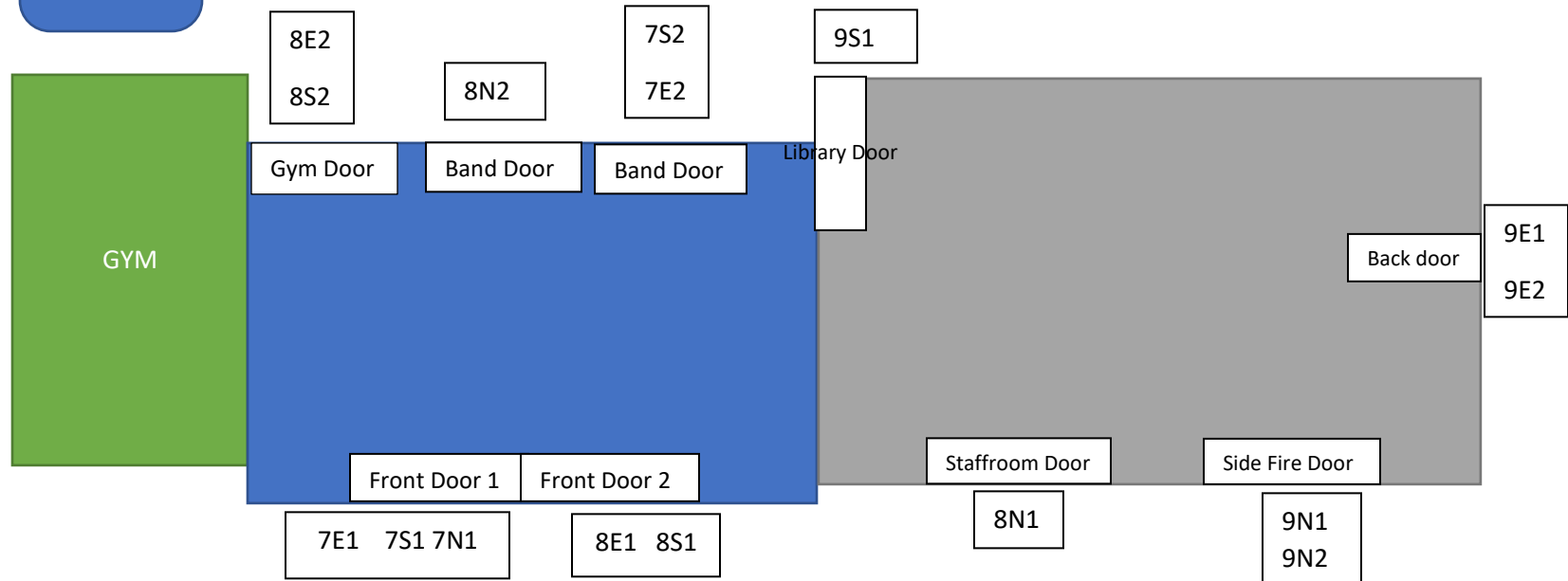

BANNING STREET

GENERAL WOLFE SCHOOL

661 Banning Street
Winnipeg, MB. R3G 2G3
Phone: 204-786-7427
Fax: 204-775-2882

Ms. G. McLean, Principal
Mr. L. Mangaron, Vice-Principal

"HOME OF THE WOLFPACK"



August 28, 2020

Dear Parents/Guardians:

Due to the COVID19 Pandemic, the structure of the General Wolfe School Lunch Program for this upcoming school year will be different to adhere to the Manitoba Public Health Protocols. It is essential we follow the guidelines from the Manitoba Public Health to keep our staff and students safe. Our lunch program will be limited to those students who live a long distance away from school or those who have a valid reason to attend the lunch program. You can register your child(ren) at no cost by way of email (generalwolfe@wsd1.org) or phone (204)-786-7427 before the school starts. The Lunch Program structure and expectations are below.

Lunch Program:

- Students will stay in their homerooms to eat their lunch from 11:45-12:40
- Students will follow social distancing protocols at all times
- Students must bring their own lunches that do not require heating as microwaves will not be available
- Students can purchase food from the "Nook" menu on a weekly basis from their homeroom teacher (lunches will be made and delivered by staff)
 - \$3 per day or \$15 per week
 - You can pay by cash or cheque (made to General Wolfe School) on a weekly basis every Thursday

Expectations:

- Respect all students and staff
- NO SHARING OF FOOD or OTHER ITEMS IN GENERAL
- Clean up
- Ensure Lunch Program is enjoyable and safe for everyone
- Students not following expectations will receive a warning and parent/guardian will be contacted
- Students with repetitive disrespectful behaviour will lose lunch program privileges

Thank you.

ATTACHMENT D:



Alverstone St.

Burnell Street

Burnell St.

STUDENT
DROP-OFF
AND
PICK-UP
AREA

Back Lane

B
A
C
K

L
A
N
E

S
T
A
F
F
P
A
R
K
I
N
G

Basketball
Court

General Wolfe School Field

GYM

Front Door 1

Front Door 2

E
L
L
I
C
E

A
V
E
N
U
E

ATTACHMENT E: PICK UP/DROP OFF AREA

BANNING STREET

Helpful Online Resources

1. Return to School Information for Parents/Guardians:
https://manitoba.ca/asset_library/en/covid/k-12-reopeningplan-guideforparents.pdf
2. Link to WSD Pandemic Planning Framework:
<https://www.winnipegssd.ca/Parents/PandemicPlanning/Documents/WSD%20Framework%20for%20School%20Planning%20during%20pandemic%20WEB.pdf>
3. Link to WSD Pandemic Planning:
<https://www.winnipegssd.ca/Parents/PandemicPlanning/Pages/default.aspx>
4. Parent/Guardian FAQ's:
https://www.winnipegssd.ca/Parents/PandemicPlanning/Documents/parent_guardian_faq.pdf
5. Restoring Safe Schools:
https://manitoba.ca/asset_library/en/covid/k-12-reopeningplan-guidance.pdf
6. COVID Online Screening Tool:
<https://sharedhealthmb.ca/covid19/screening-tool/>
7. Homeschooling Information:
<https://www.edu.gov.mb.ca/k12/schools/ind/homeschool/index.html>
8. Healthy Minds Mental Health and Wellness Resource Guide:
<https://www.winnipegssd.ca/healthyminds/Pages/Healthy-Minds-Mental-Health-and-Wellness-Resources.aspx>
9. Manitoba Education: Well Being and Mental Health Resources:
https://www.edu.gov.mb.ca/k12/covid/support/rssn_docs/mental_health_res.pdf
10. Government of Manitoba: Mental Health Virtual Therapy Program:
<https://www.gov.mb.ca/covid19/bewell/virtualtherapy.html>